

## Inogen One® G3 Column Change Procedure

**NOTE** Column change instructions are only to be used when maintenance is required and are not intended for practice purpose.

1. Turn off the Inogen One® G3 concentrator by pressing the power button to shut down the device.
2. Remove the Inogen One® G3 concentrator from the carry bag.
3. Remove the battery from the Inogen One® G3 concentrator.

4. Turn Inogen One® G3 over so that it is standing in the upside down position where the display panel is facing down and the bottom of the Inogen One® G3 is facing up.



5. There are two columns (metal tubes) on the Inogen One® G3 concentrator and one is located on each side of the device.

6. Remove column by pressing the latch button with thumb or finger.

Open and unlocked

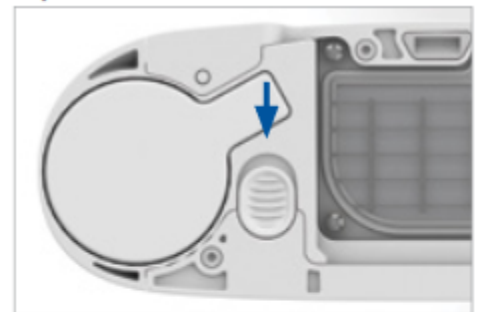

7. While holding the button open, slide the column (metal tube) out by gripping the exposed aluminum surface with other hand.



## Cleaning, Care and Maintenance Chapter 6

8. Remove the column (metal tube) completely from the Inogen One® G3.



9. Repeat steps 6-8 to remove the other column (metal tube).

### Column (metal tube) Installation

10. Remove dust caps of new column (metal tube).  
Make sure there is no dust or debris where the dust caps were located.

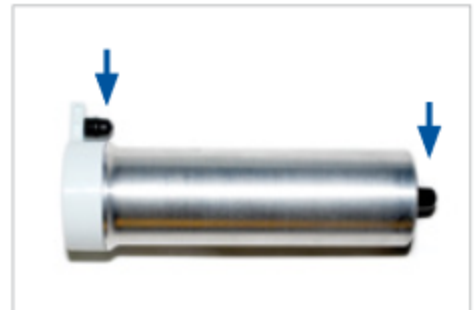

11. Insert column (metal tube) into the Inogen One® G3 concentrator. Do not leave the column exposed; it should be inserted into the Inogen One G3 as soon as the dust caps have been removed.



12. Push the column (metal tube) into the device such that the column (metal tube) is fully seated into the Inogen One® G3 concentrator. The spring loaded latch button should fully return to the closed position.

Closed and locked

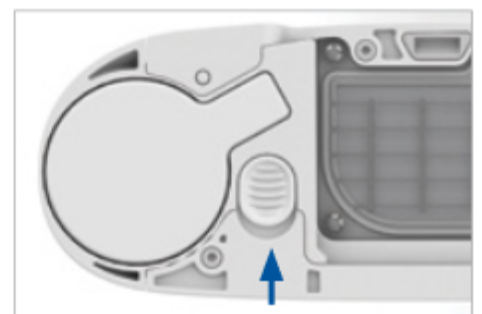

13. Repeat steps 10-12 to install the other column (metal tube).

## Cleaning, Care and Maintenance Chapter 6

14. Connect the AC power supply cord to the Inogen One® G3 and plug the power supply AC cord into an electrical outlet. **Do Not Power on the Inogen One® G3 concentrator.**
15. Press and hold the light button for 10 seconds and screen will display “sieve reset” message. Release button once message is displayed on screen.
16. Press the bell button once and screen will display “sieve reset successful”.
17. Press the power  button to turn on the Inogen One® G3, and use normally.



**WARNING** Do not use any columns other than those specified in this user manual. The use of non-specified columns may create a safety hazard and/or impair equipment performance and will void your warranty.

### Other Service and Maintenance



**WARNING** Do not disassemble the Inogen One® G3 or any of the accessories or attempt any maintenance other than tasks described in this user manual; disassembly creates a hazard of electrical shock and will void your warranty. Do not remove the tamper evident label. For events other than those described in this manual, contact your equipment provider for servicing by authorized personnel.

**CAUTION** Do not use lubricants on the Inogen One® G3 or its accessories.

## Disposal of Equipment and Accessories

Follow your local governing ordinances for disposal and recycling of the Inogen One® G3 and accessories. If WEEE regulations apply, do not dispose of in unsorted municipal waste. Within Europe, contact the EU Authorized Representative for disposal instructions. The battery contains lithium ion cells and should be recycled. The battery must not be incinerated.

## Maintenance Items List

- Inogen One® G3 single battery (model # BA- 300)
- Inogen One® G3 double battery (model # BA- 316)
- Replacement intake particle filters (model # RP- 301)
- Output Filter Replacement Kit (model # RP-107)
- Inogen One® G3 columns (model # RP-321)

For assistance, if needed, in setting up, using, maintaining, or to report unexpected operation or events, contact your equipment provider, or manufacturer.